

studio building PHL-Art • Hasselt Belgium

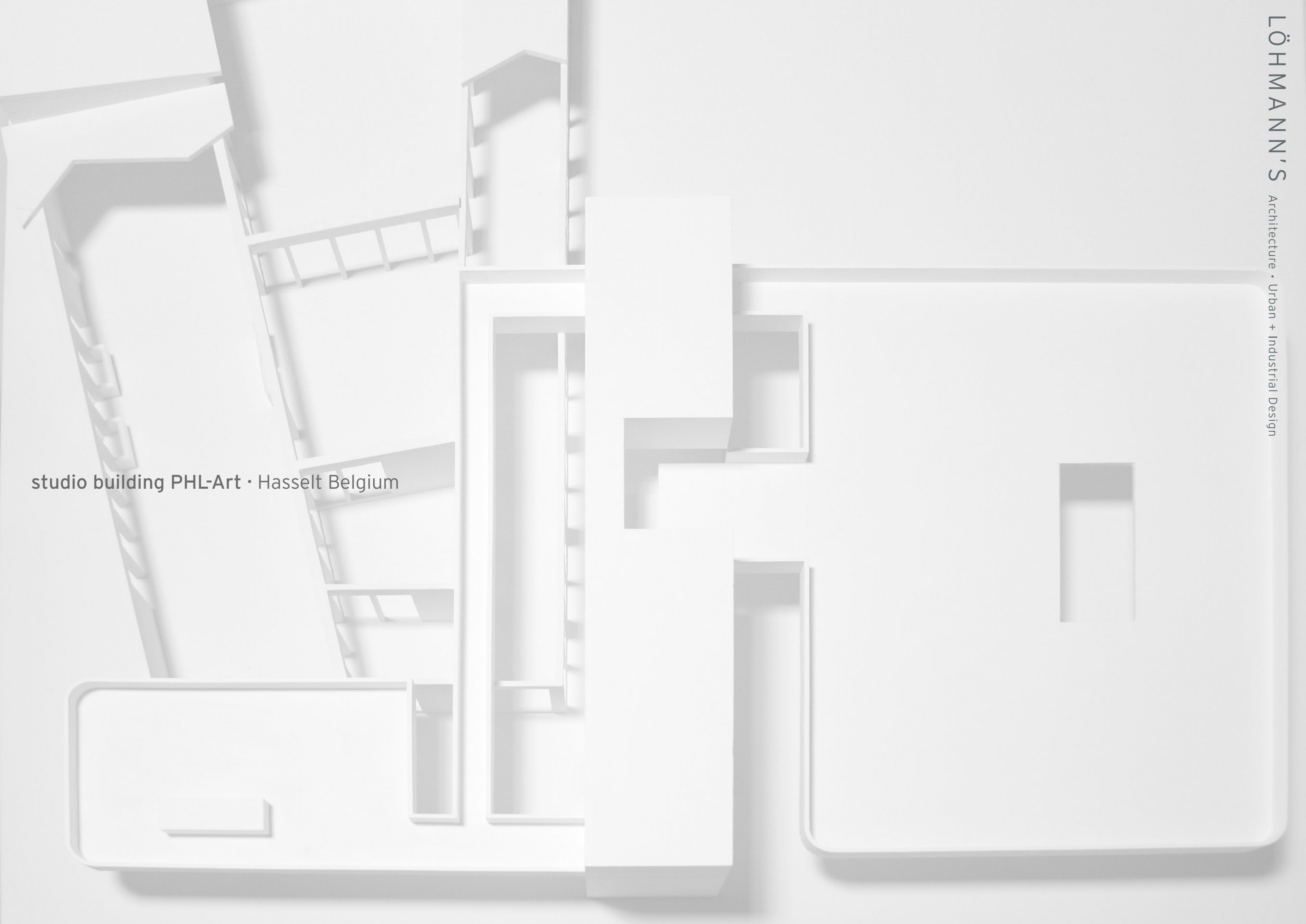

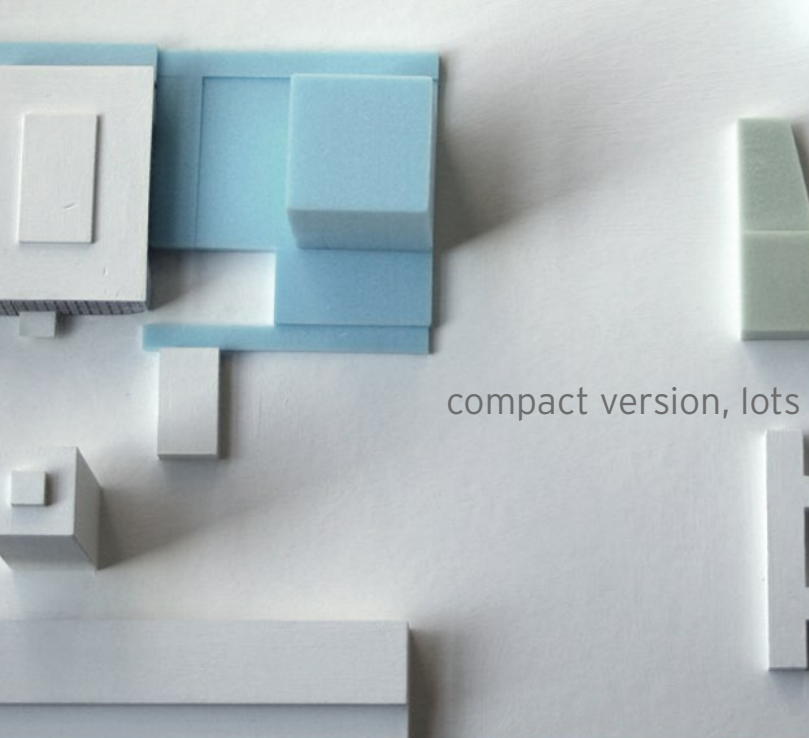

compact version, lots of stacking, integration? exterior space?

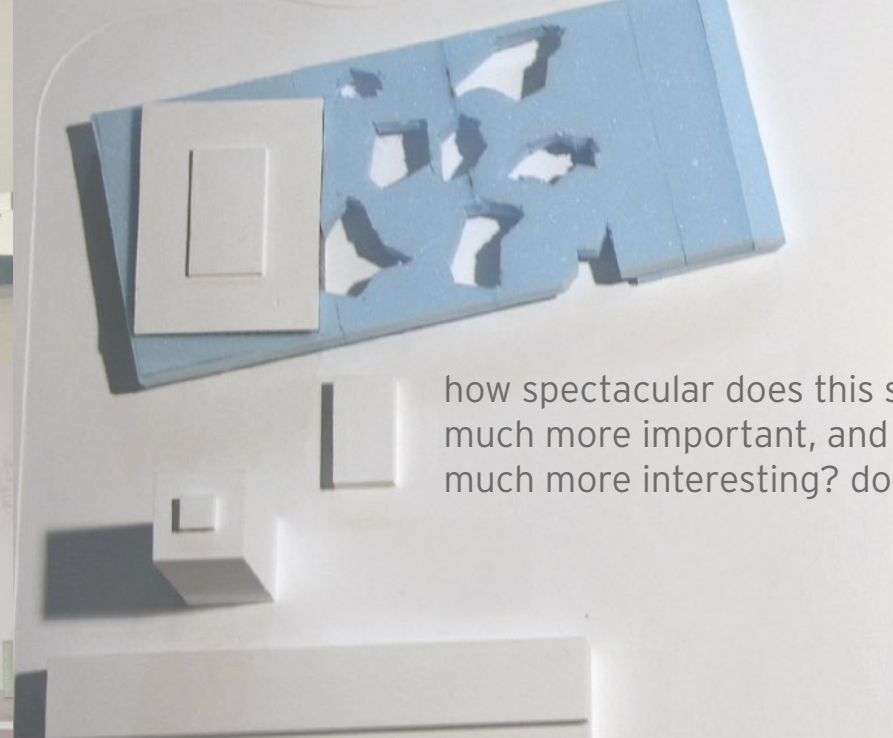
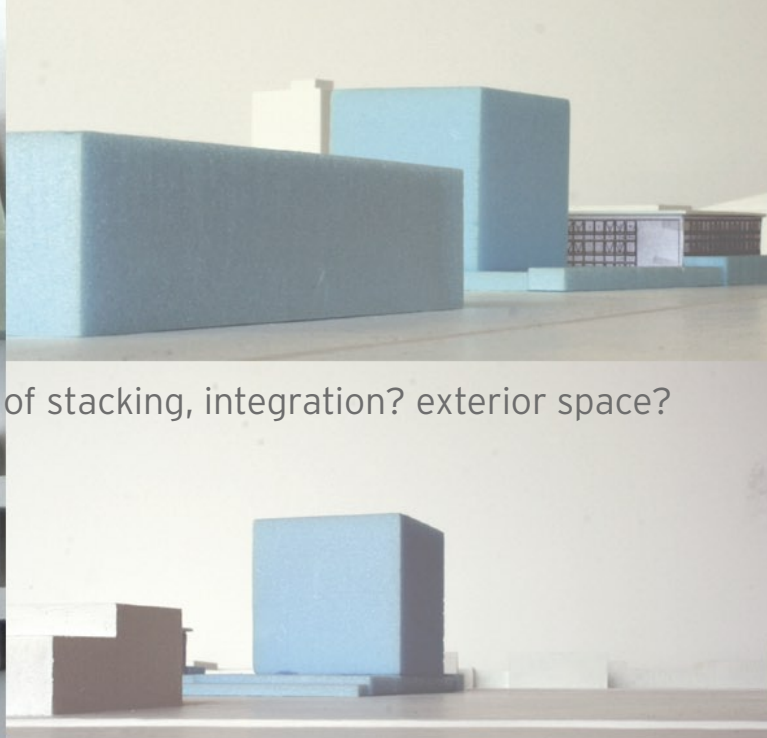

how spectacular does this school need to be? isn't integration much more important, and isn't creativity with modest means much more interesting? doesn't the budget hint at this?

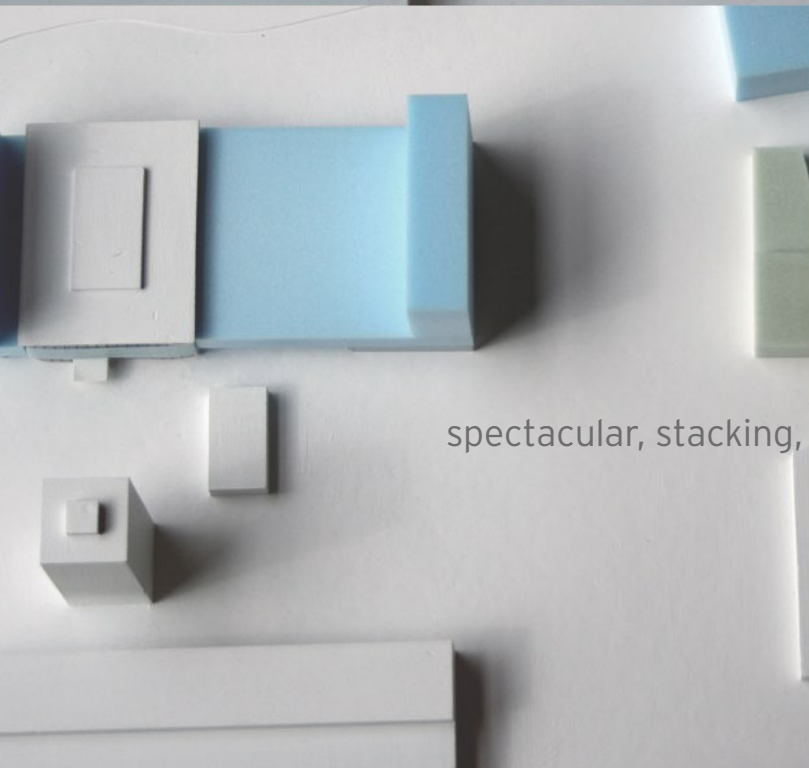

spectacular, stacking, integration? exterior space?

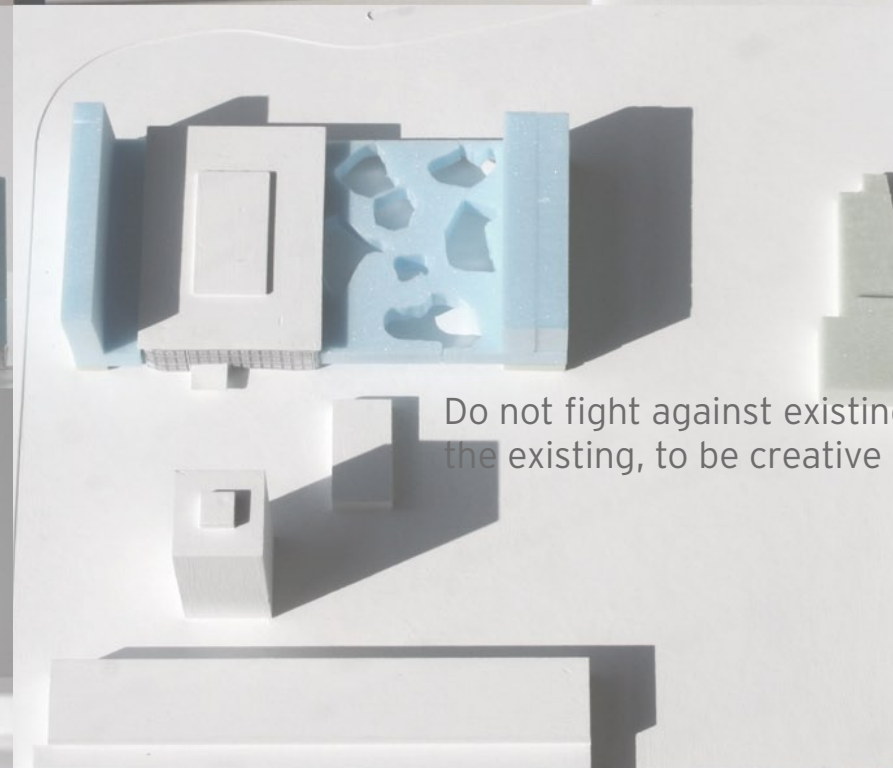
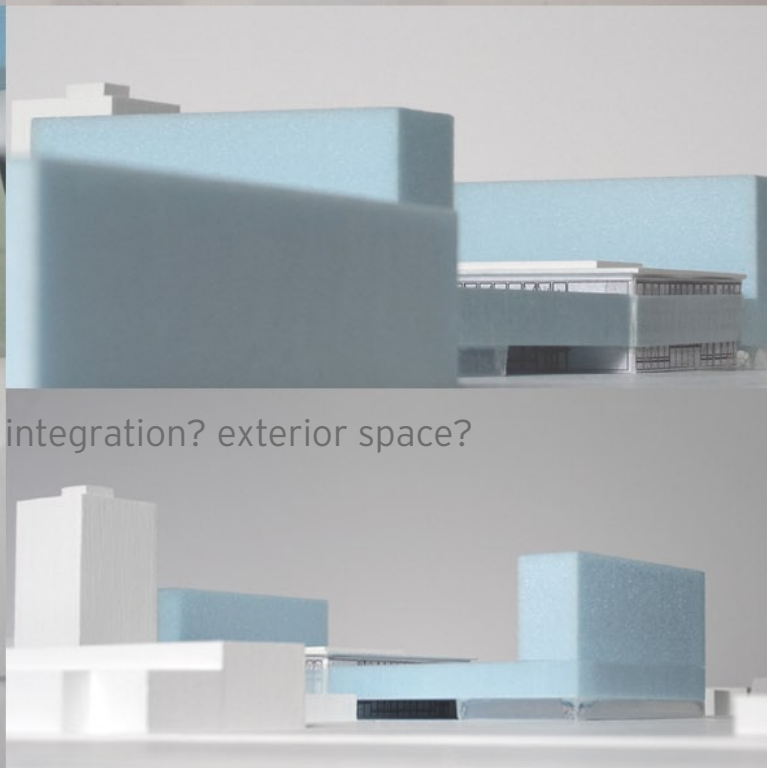

Do not fight against existing energies, but use them. To accept the existing, to be creative with it, to interpret

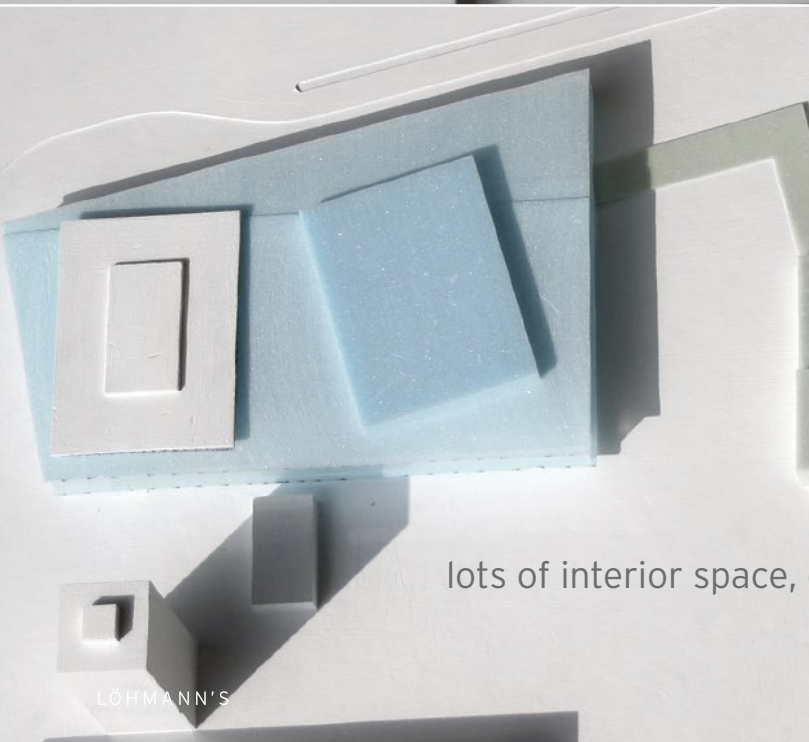
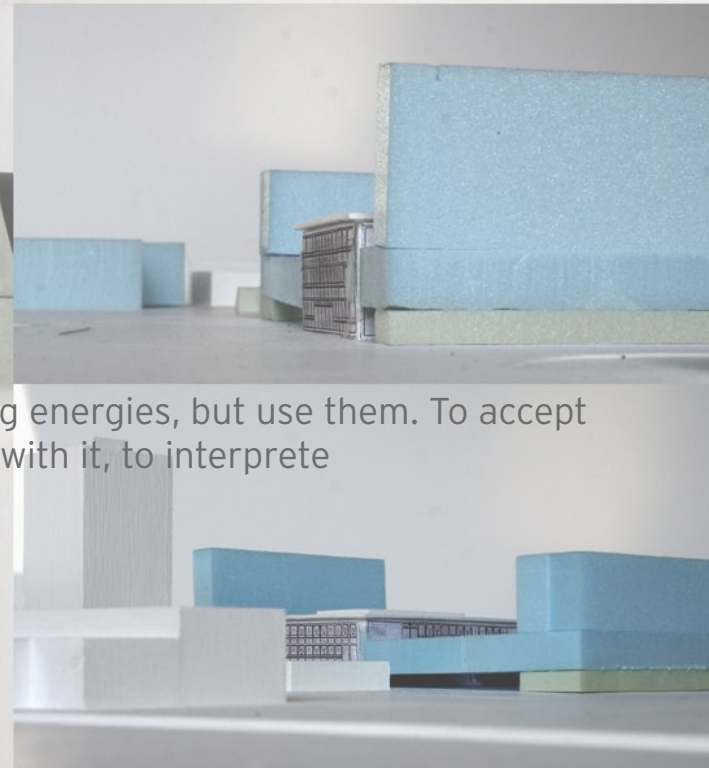

lots of interior space, contextual

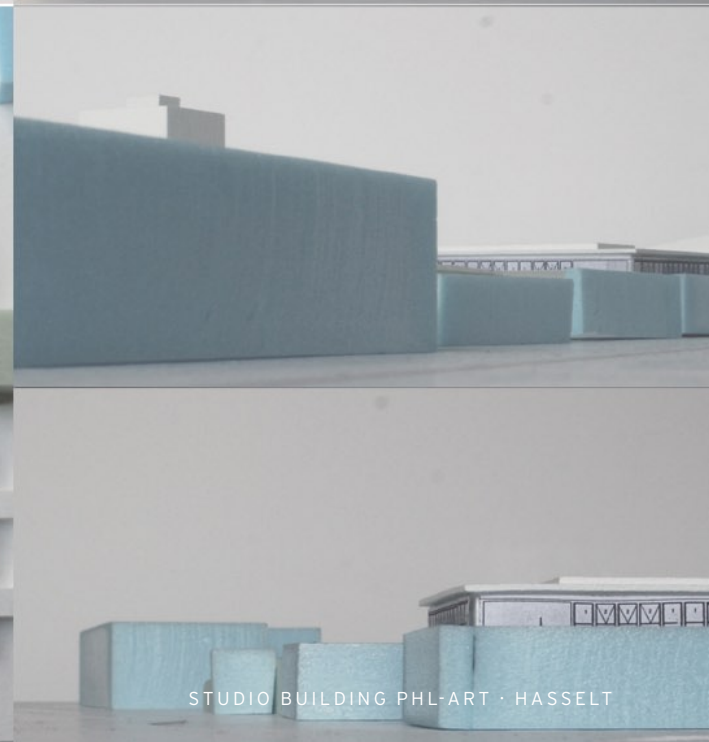
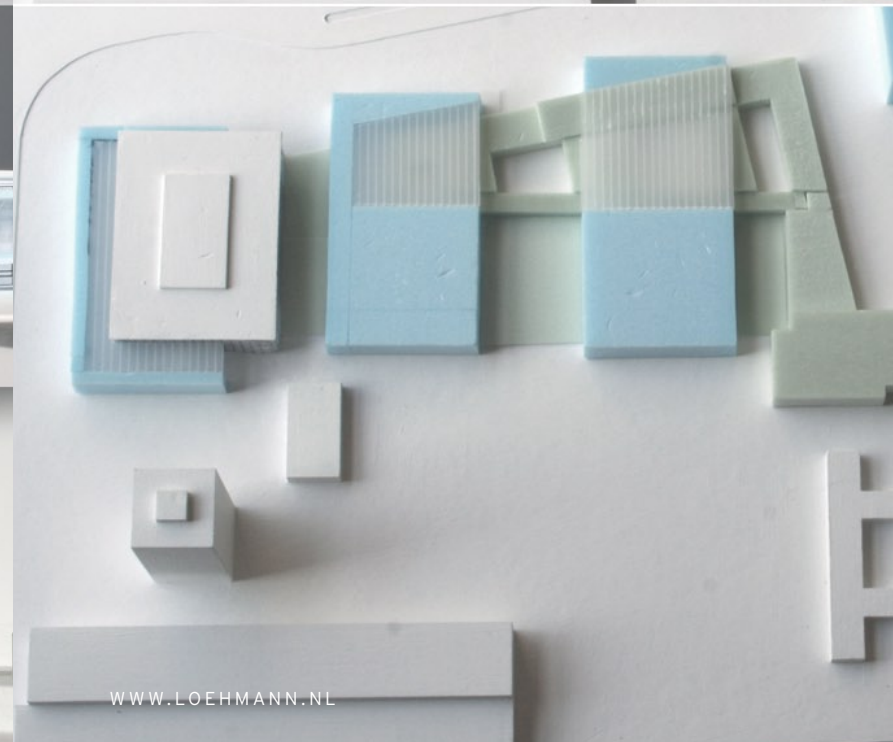
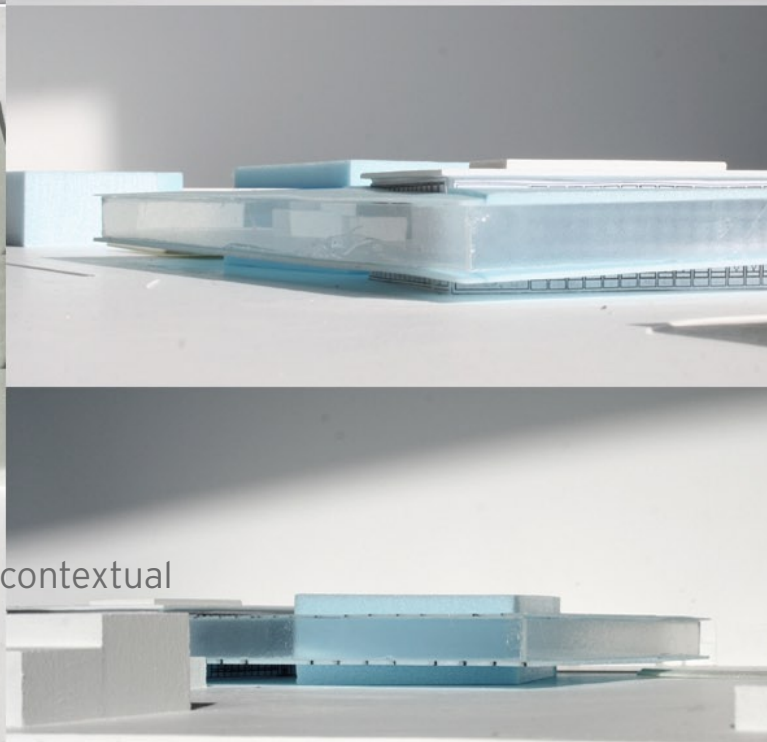



The brief demands a vision for the expansion of the existing studio building. It leaves open whether the existing building is maintained and extended, or removed and replaced with a completely new building. A vision on the utility value of the campus is also part of the competition. Decisive for us were a number of questions that we consider essential for this project: What makes the campus 'workable' for education and daily life for students and teachers? To what degree should the building be adjustable to changing visions on education, while being able to retain its identity? Where and how do exchanges between the various arts take place, and how does this relate to the characteristics of the process of experimentation and making? What role can the arts play in and during the production of architecture? Historical research and analysis of art schools and the development of arts education, analyses of campus organisations, systematical research of the possible direct and indirect roles that art can play in the design process, interviews with artists etcetera, enabled us to take positions in all these

questions and define a framework within which the architectonic answer to the assignment should be sought. Within this framework we were able to formulate a very rich answer, despite the very limited budget available for the extension. The 1950s building, with its rich spatial conditions of courtyards, wide corridors and very extraordinary spaces which are very well suited for multiple forms of informal meetings. Over this volume, two similar industrial halls are projected. A third hall with the same dimensions is connected to the main building. Outwardly, in their repetition the three halls form an powerful ensemble with the existing buildings. The façade contains fields that in the course of time could be filled in by the various artistic disciplines. The building will continually change and tell a story about the developments in the arts and education. The extensive research about the abovementioned themes are bundled in a book which we propose to use as a workbook during the design process with all those involved.

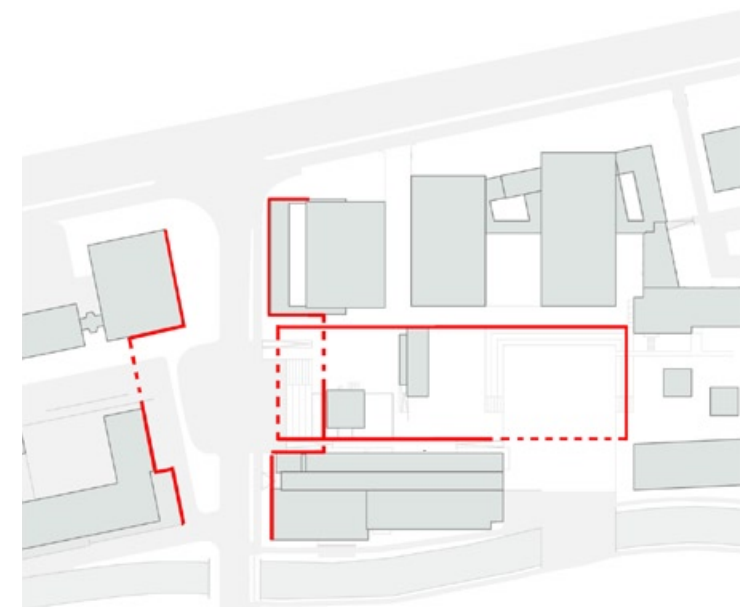
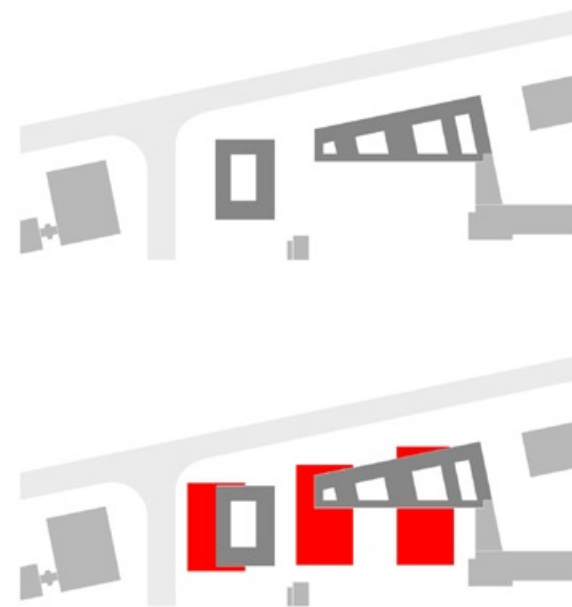



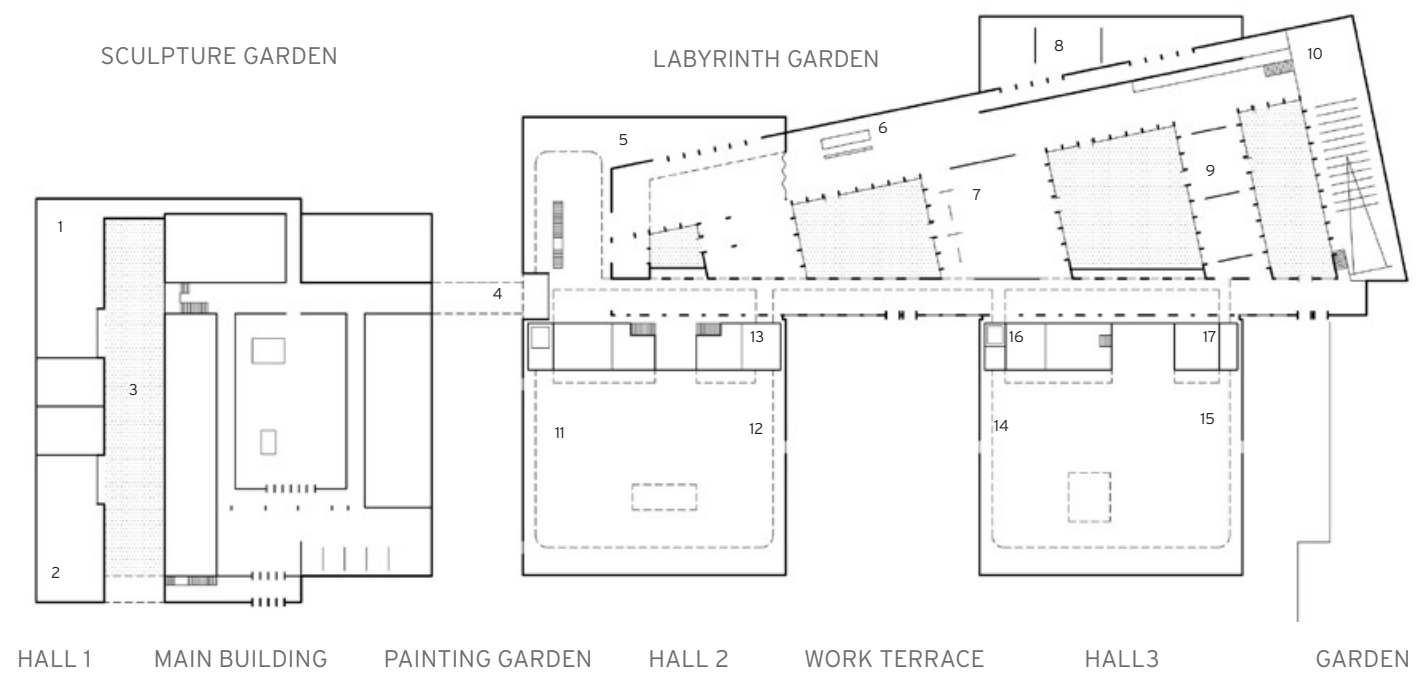

1 · gallery 2 · art supplies 3 · courtyard 4 · entrance studio building 5 · presentation room 6 · espressobar 7 · teacher's room
 8 · guest teachers 9 · laboratory 10 · theory classroom 11 · painting 12 · glass sculpture 13 · ovens 14 · ceramics
 15 · sculpture 16 · plaster room 17 · wood + metal workshop

Credits

Out of a selection of 140 architects LÖHMANN'S is one of the 5 offices invited to develop a proposal for the atelier-building for the Arts department of the Provinciale Hogeschool Limburg in Belgium

<i>Client</i>	Provinciale Hogeschool Limburg
<i>Size</i>	3.000 m ²
<i>Project architect</i>	Heike Löhmann
<i>Collaborator</i>	Enrique Otero Neira
<i>Assistent layout</i>	Stan van der Maas
<i>Consultant BT</i>	ARTEX bvba · Dendermonde België
<i>Structural engineer</i>	ir. Frans S. de Zwart · Corsmit · Rijswijk
<i>Cost consultant</i>	David Meier · Vitruvius Consultancy · Oss
<i>Photography</i>	Heike Löhmann

